

Pre-Delivery Service

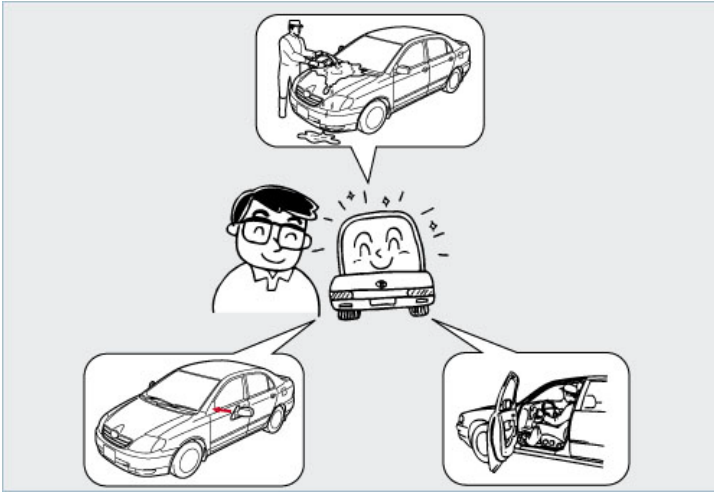

Purpose of Pre-Delivery Service

PDS (Pre- Delivery Service) is performed by the dealer before a new vehicle is delivered to the customer in order to ensure that it is in optimal condition, and that the customer can operate it immediately upon taking delivery.

PDS consists of the following three operations:

1. Verifying the condition of the vehicle.
2. Restoring the vehicle to operating condition.
3. Inspecting the functions of the vehicle.

HINT:

PDS: The dealer performs the inspection.

PDI (Pre- Delivery Inspection): The distributor performs the new car quality inspection.

(1/1)

Verifying the Conditions of the Vehicle

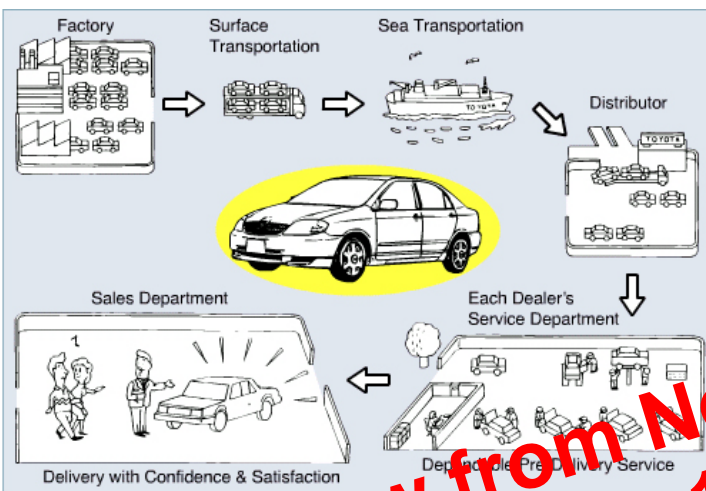

Description

Final inspection is completed by the manufacturer before a new vehicle is transported to the customer. Various problems may occur during transport, such as physical damage. For this reason, it is necessary to verify that the vehicle is free of problems when the vehicle arrives at the dealer.

Preview from Notesale.co.uk
Page 1 of 6

(1/1)

Restoring the Vehicle

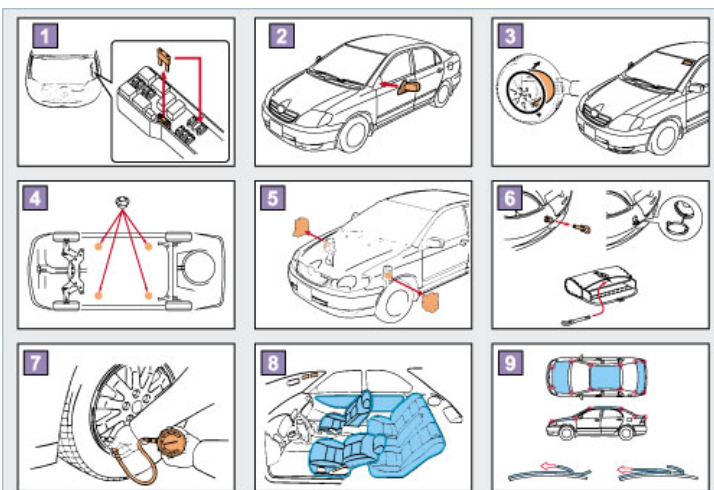

Restoring the Vehicle

To prevent problems during transport, various protective measures are taken with the vehicle before it leaves the factory. Therefore, the vehicle must be restored to operating condition during a PDS. If the vehicle cannot be restored to operating condition, the vehicle might not be able to function properly, or the unrestored portion could lead to an unforeseen accident.

- 1 Installing of fuses and short pins
- 2 Installing of factory- loaded parts
- 3 Removing rust- preventive covers from brake discs
- 4 Installing rubber body plugs
- 5 Removing front spring spacers
- 6 Removing emergency towing eyelets
- 7 Adjusting tire air pressure
- 8 Removing unnecessary labels, tags, stickers, etc.
- 9 Removing body protective film

(1/10)